

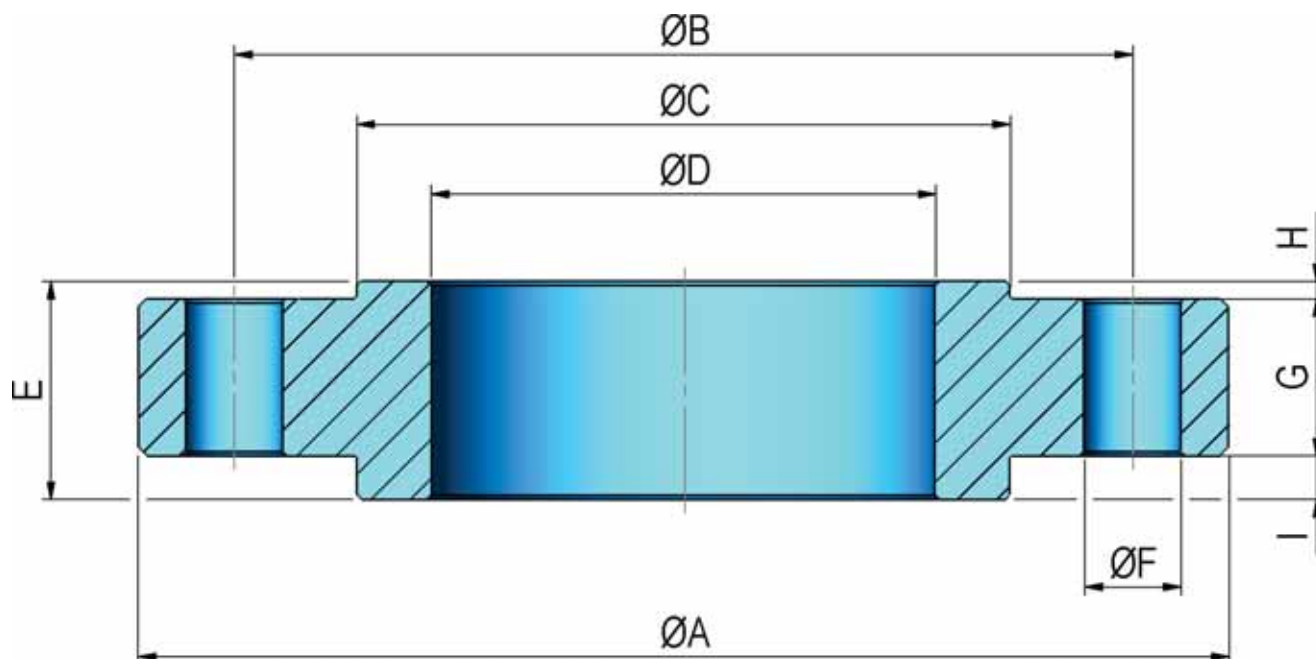

BRIDA DELANTERA Y TRASERA FRONT AND REAR BRIDLE BRIDE AVANT ET ARRIÈRE



REF CODE	ØA	ØB	ØC	ØD	E	ØF	G	H	I	Peso (kg) Weight Poids
B703315N6T7	70	57	42	33	13,5	7	12	1,5	1,5	0,27
B804019N6T7	80	67	52	40	17	7	15	2	2	0,44
B1004822N6T9	100	82	60	48	17	9	15	2	5	0,72
B1255825N6T11	125	103	75	58	20	11	18	2	5	1,37
B1456827N6T13	145	120	90	68	22	13	20	2	5	2,04
B1457327N6T13	145	120	90	73	22	13	20	2	5	1,93
B1607831N6T15	160	130	100	78	26	15	24	2	5	2,85
B1608331N6T15	160	130	100	83	26	15	24	2	5	2,70
B1709335N6T15	170	142	110	93	30	15	28	2	5	3,41
B20211338N6T17	202	170	135	113	33	17	30	3	5	5,13
B250M14550N6T21	250	210	170	M145x2	43	21	40	3	7	10,23
B280M15950N6T21	280	230	190	M159x2	43	21	40	3	7	13,30
B320M17867N6T29	320	270	215	M178x2	57	29	54	3	10	23,16
B385M22880N6T32	385	330	270	M228x2	68	32	65	3	12	37,47

MAT.: F-1110 / ST52